

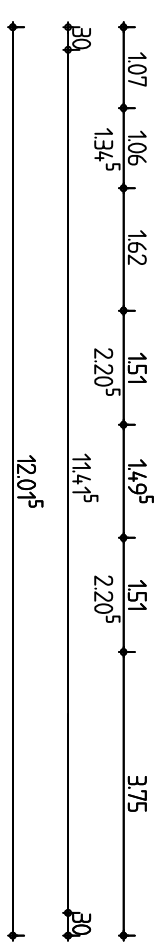

ICON 4.01 EINGANGSVARIANTE 3 ROYAL

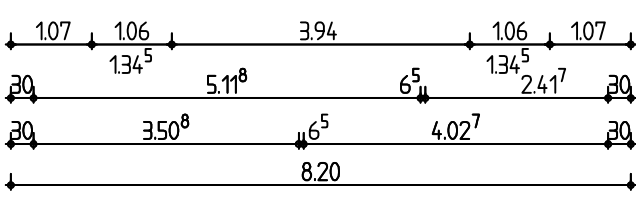
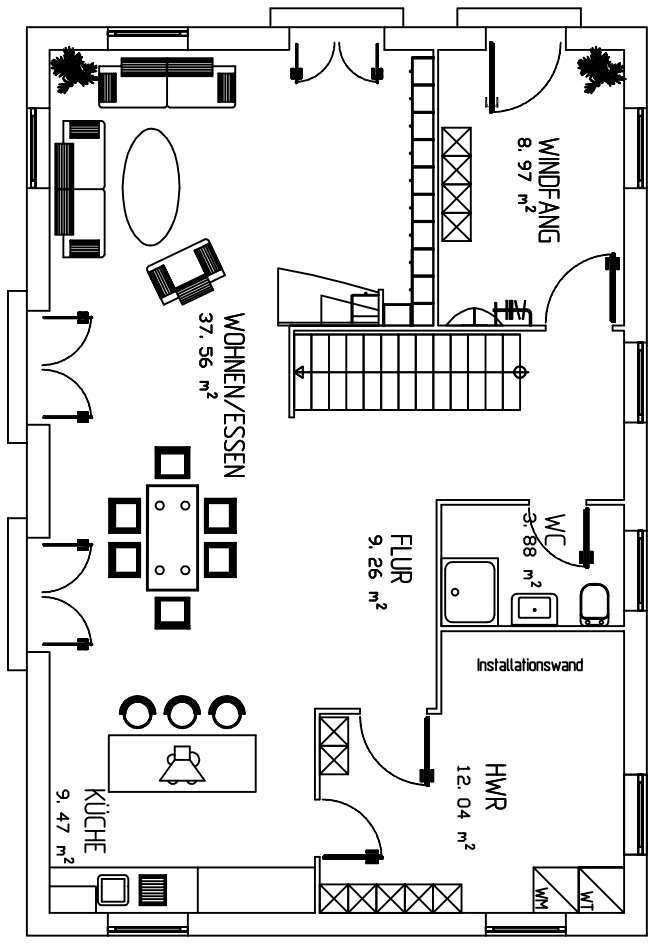
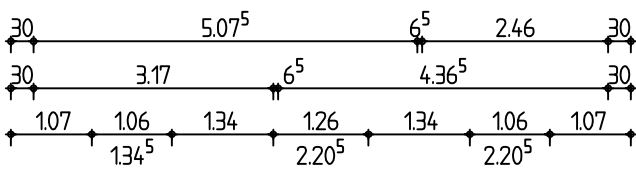
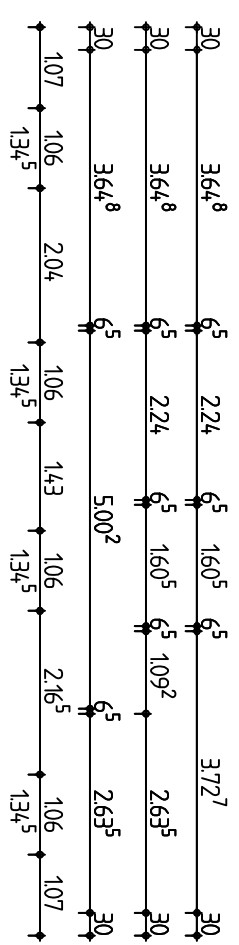

Änderungen:	Name:	Datum:	 Vdt Demmert KG Tel.: 09552/71-0 Fax.: 09552/71-187	Name:	Datum:	
ÜBERARBEITUNG	Feller St.	03-03-06		Gez.:	Feller St.	02-11-27
FENSTERGROESSEN	Luft N.	05-05-04		Gepr.:		
ÜBERARBEITUNG	Luft N.	07-03-22		Maßstab:	1:100	
Zeichnung: EINGANGSVARIANTE 3			Plan-Nr.:	9		
ICON 4.01 ROYAL						